



2095 Route 1

North Brunswick, New Jersey

Availability

- +/- 5,100 SF (Divisible) with Drive-Thru

Traffic Count

- 83,054 VPD on Route 1

Site Description

- Strategically located directly within the heart of North Brunswick's Route 1 retail corridor
- Layout is flexible with proposed preliminary plan consisting of a 5,100 SF multi-tenant pad with drive-thru
- Adjacent to Staybridge Suites with cross-easement into site

Demographics

Radius	Population	Total Daytime Population	Median Household Income
1 Mile	13,231	10,408	123,500
3 Mile	75,063	59,454	108,400
5 Mile	217,908	179,235	102,400

For Sale - Contact

Wes Craft
Ph. 203-522-7484

PIERSON
COMMERCIAL REAL ESTATE®

2095 Route 1

North Brunswick, New Jersey

State Map

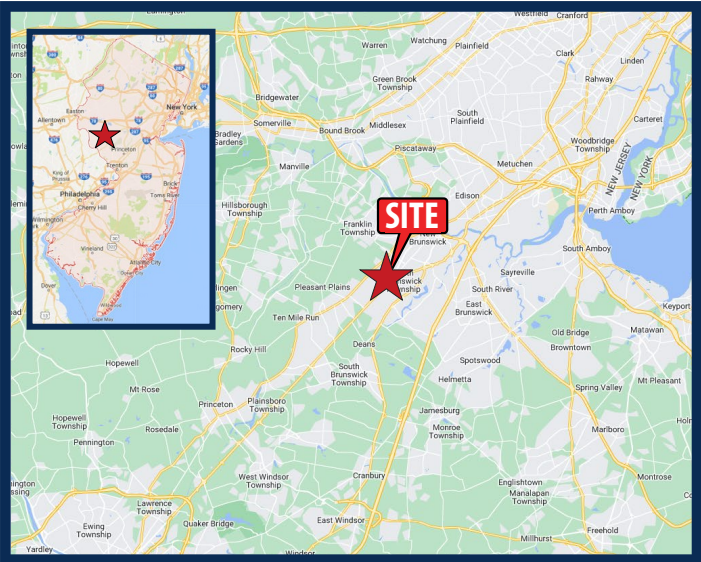

Preliminary Proposed Site Plan

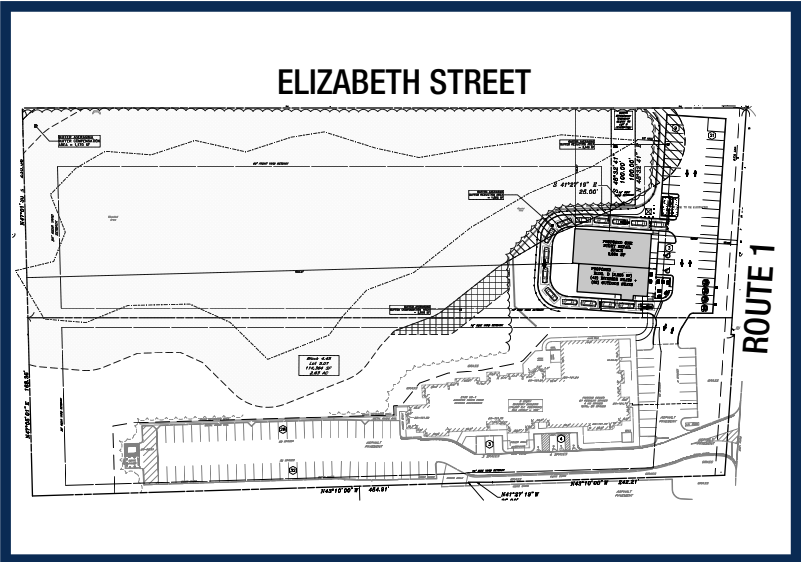

Market Aerial



For Sale - Contact

Wes Craft
Ph. 203-522-7484

PIERSON
COMMERCIAL REAL ESTATE.

© Pierson Commercial Real Estate LLC. This information has been obtained from sources believed reliable. We have not verified it and make no guarantee, warranty or representation about it. Any renderings, mobile data, general data, projections, opinions, assumptions or estimates used are for example only and do not represent the current or future performance of the property. You and your advisors should conduct a careful, independent investigation of the property and data to determine to your satisfaction the suitability of the property for your needs.