

**FOR SALE**

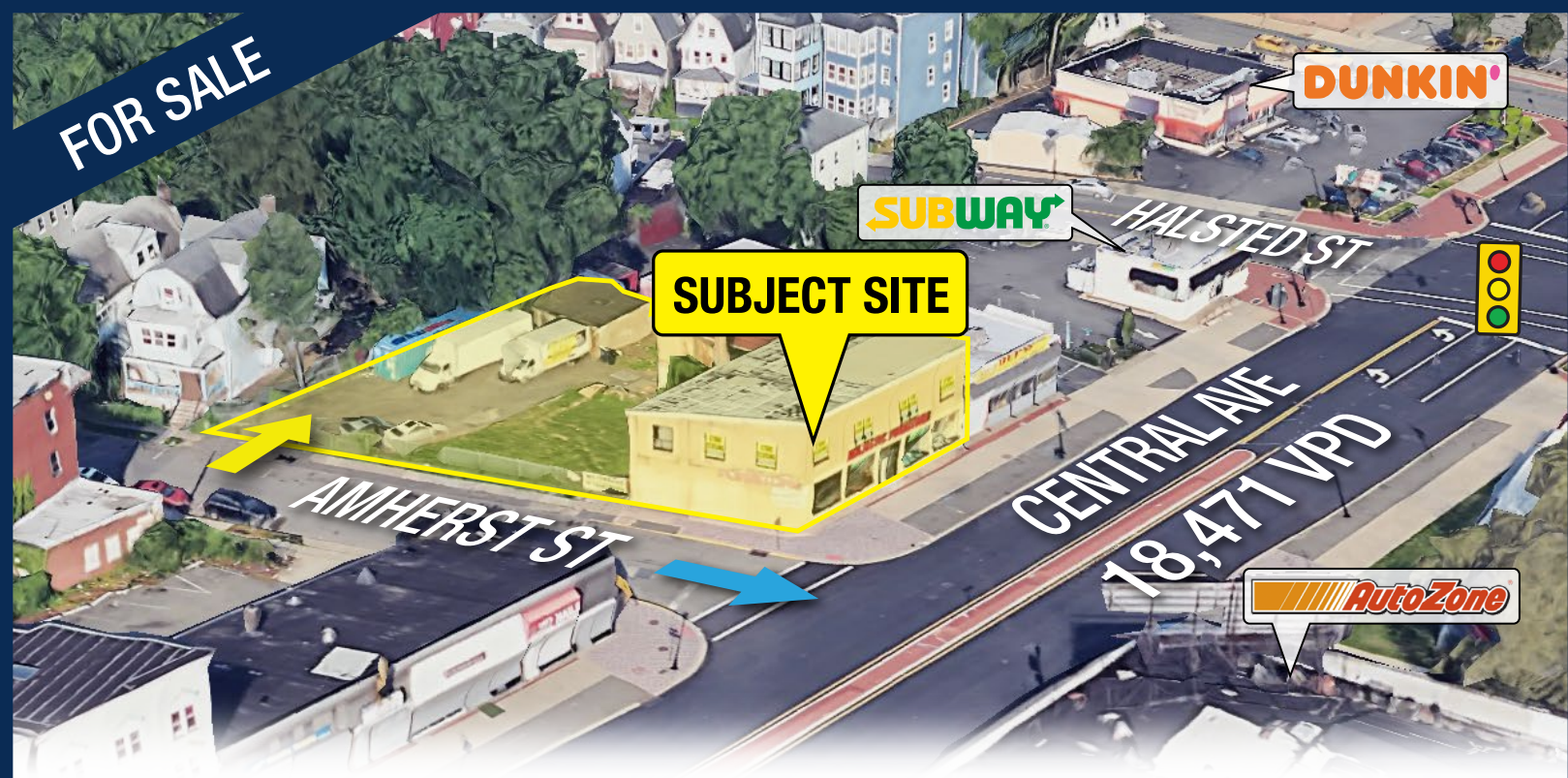

## 501-505 Central Avenue (Block 492, Lots 41, 42 & 43) East Orange, New Jersey

Size	Acreage	Asking Price	Taxes
<ul style="list-style-type: none"><li>• +/- 3,464 SF (Ground Floor)</li><li>• +/- 3,433 SF (Second Floor)</li><li>• Partial basement</li></ul>	<ul style="list-style-type: none"><li>• +/- 0.28 Acres</li></ul>	<ul style="list-style-type: none"><li>• \$999,000</li></ul>	<ul style="list-style-type: none"><li>• \$25,497</li></ul>

### Zoning: CAC - Central Avenue Commercial District

- Cafes
- Financial Institutions
- General Medical Uses
- General Office Uses
- General Retail Sales & Retail Services
- Gyms
- Health Clubs
- Restaurants

### Demographics

Radius	Population	Total Daytime Population	Median Household Income
1 Mile	44,005	35,151	\$57,520
3 Mile	310,058	238,232	\$63,369
5 Mile	777,534	723,795	\$65,433

### For Sale - Contact

Robert Mackowski  
Ph. 732-724-4089  
rob@piersonre.com

**PIERSON**  
COMMERCIAL REAL ESTATE®



# 501-505 Central Avenue (Block 492, Lots 41, 42 & 43) East Orange, New Jersey

## Site Description

- Offered for sale, 501-505 Central Avenue is a two-story building located at the corner of Central Avenue and Amherst Street in East Orange
- Great signage opportunity on multiple sides of the building
- Easy access to the Garden State Parkway and Route 280
- Building can be delivered vacant

## Market Aerial

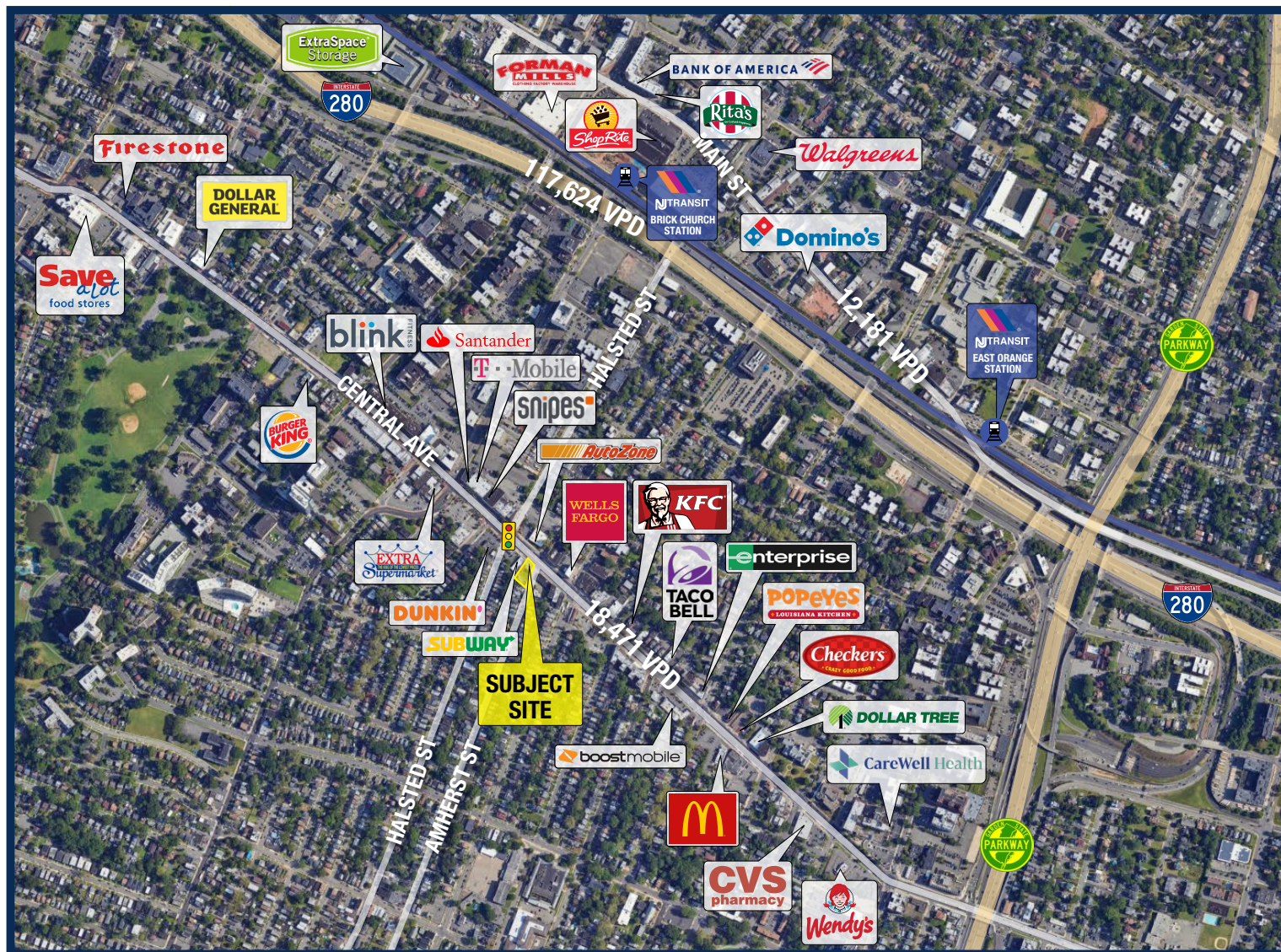

## For Sale - Contact

Robert Mackowski  
Ph. 732-724-4089  
rob@piersonre.com

**PIERSON**  
COMMERCIAL REAL ESTATE®



# 501-505 Central Avenue (Block 492, Lots 41, 42 & 43) East Orange, New Jersey

## State Map

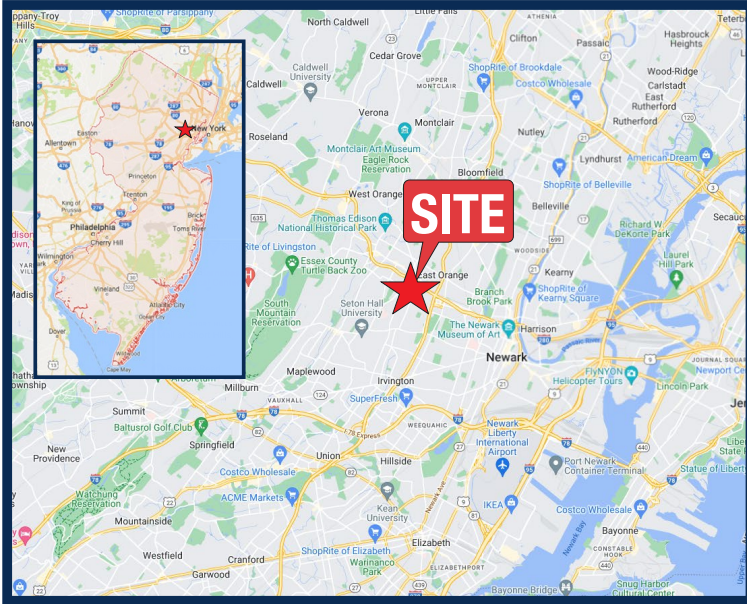

## Site Plan

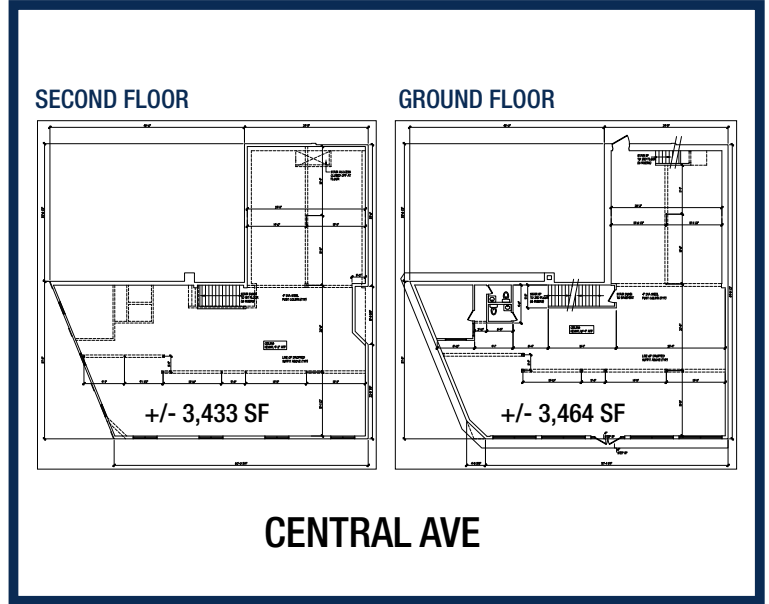

## Micro Market Aerial



## For Sale - Contact

Robert Mackowski  
Ph. 732-724-4089  
rob@piersonre.com

**PIERSON**  
COMMERCIAL REAL ESTATE®

© Pierson Commercial Real Estate LLC. This information has been obtained from sources believed reliable. We have not verified it and make no guarantee, warranty or representation about it. Any renderings, mobile data, general data, projections, opinions, assumptions or estimates used are for example only and do not represent the current or future performance of the property. You and your advisors should conduct a careful, independent investigation of the property and data to determine to your satisfaction the suitability of the property for your needs.