

**PRIME CORNER OPPORTUNITY
RARE DEDICATED RETAIL PARKING**



**AVAILABLE
+/- 2,600 SF**

Vermella Harrison

1100 Frank E. Rodgers Boulevard South, Harrison, New Jersey

Availability

- +/- 2,600 SF

Co-Tenants

- All Season Childcare
- CKO Kickboxing
- Enjoyabowls
- Joia Restaurant

Project Facts

- Approximately 14,937 SF of ground floor retail
- 398 residential units with high-end amenities within the building
- Over 6,000 residential units in surrounding new projects
- Adjacent to Red Bull Arena
- Only mixed-use building in Harrison with dedicated on-site parking for retail customers
- Within 2 blocks of the PATH station
- Potential for outdoor space
- Large restaurant exhaust chase in place

Demographics

Radius	Population	Daytime Population	Average Household Income
1 Mile	56,474	99,192	\$64,440
2 Mile	144,161	237,305	\$57,965
3 Mile	270,083	357,165	\$55,238

Retail for Lease - Contact

Gregg Medvin
Ph. 732-724-3962
gregg@piersonre.com



Vermella Harrison

1100 Frank E. Rodgers Boulevard South, Harrison, New Jersey

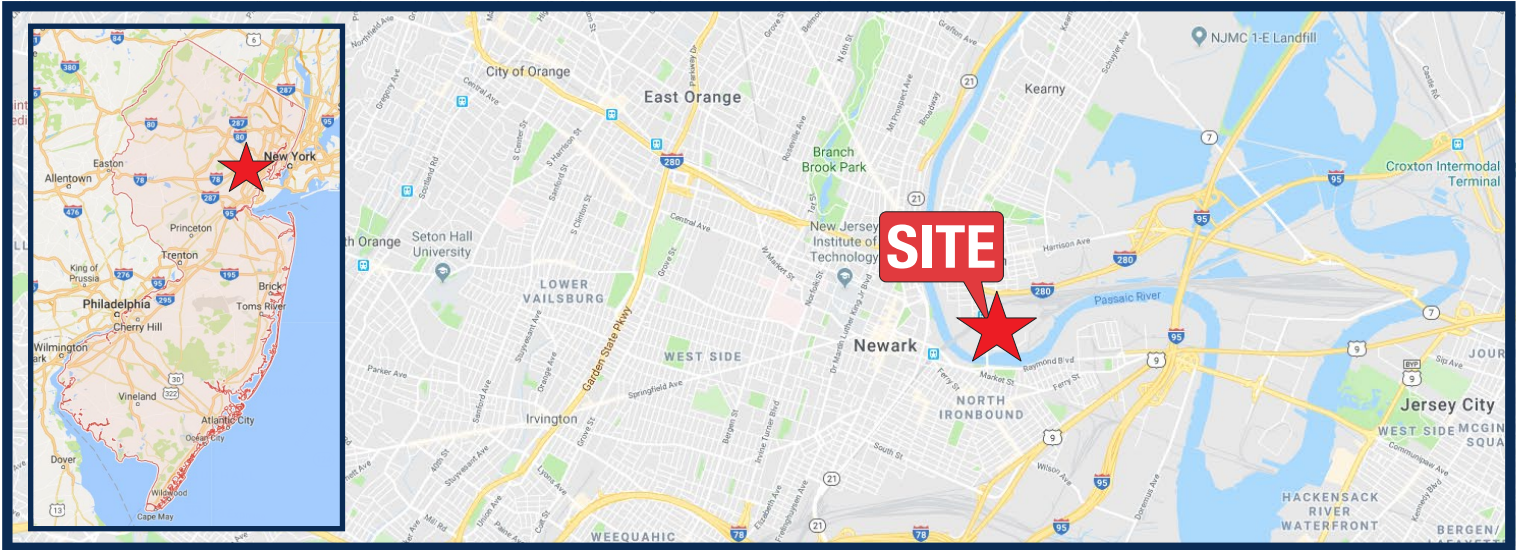

Retail for Lease - Contact

Gregg Medvin
 Ph. 732-724-3962
gregg@piersonre.com

PIERSON
 COMMERCIAL REAL ESTATE®

© Pierson Commercial Real Estate LLC. This information has been obtained from sources believed reliable. We have not verified it and make no guarantee, warranty or representation about it. Any renderings, mobile data, general data, projections, opinions, assumptions or estimates used are for example only and do not represent the current or future performance of the property. You and your advisors should conduct a careful, independent investigation of the property and data to determine to your satisfaction the suitability of the property for your needs.

Vermella Harrison

1100 Frank E. Rodgers Boulevard South, Harrison, New Jersey

- Upscale mixed-use building adjacent to Red Bull Arena with 398 residential units and approximately 14,937 square feet of ground floor retail
- Densely populated market with over 270,000 people living within 3 miles as well as a daytime population of approximately 357,000 within 3 miles
- Within steps of the Harrison Path Station with approximately 8,900 average weekday riders with direct access to Manhattan
- Harrison is currently within an exponential growth pattern with additional mixed-use projects that will offer over 6,000 residential units
- Street parking and a parking garage with ample designated parking

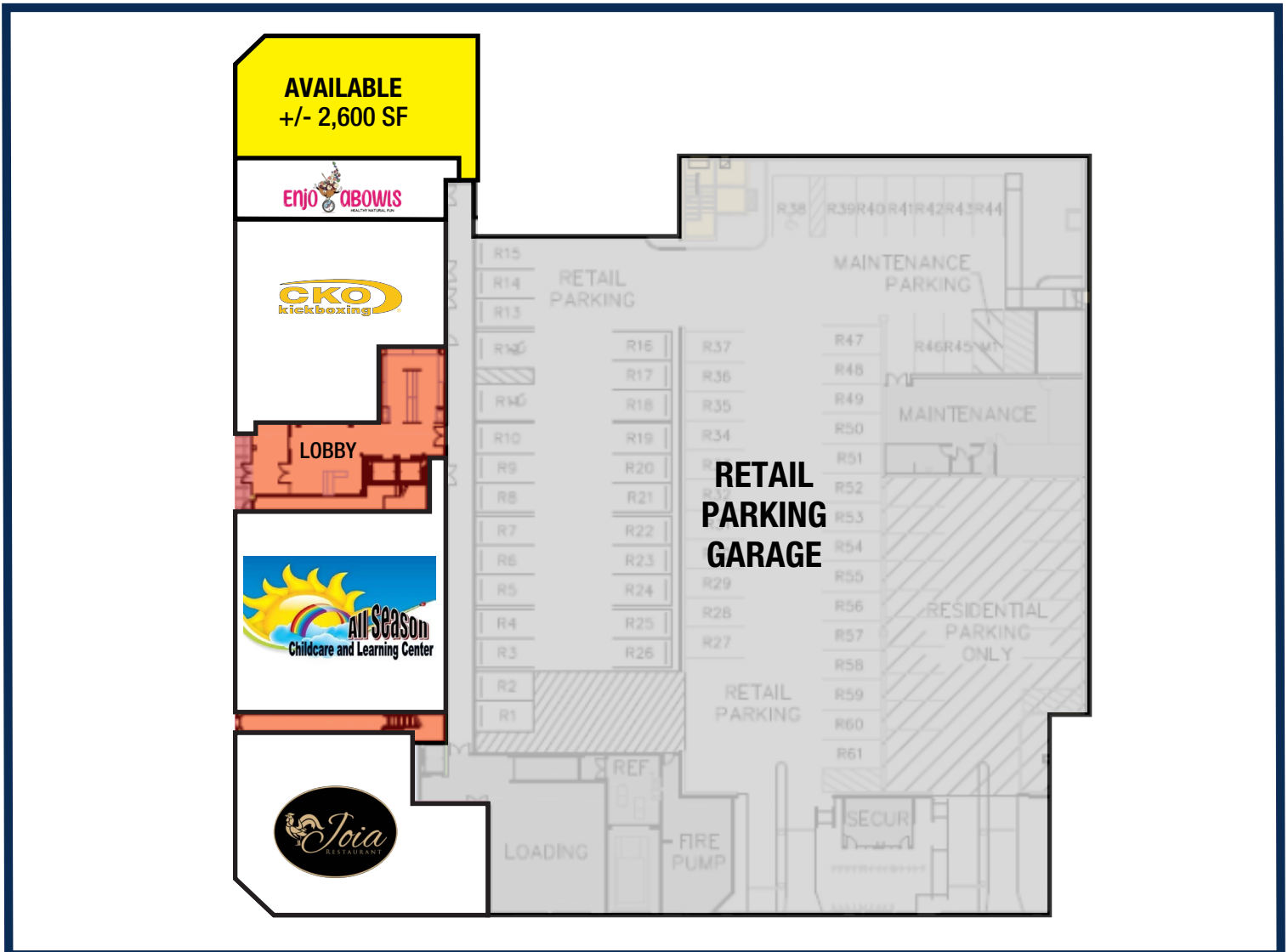

Retail for Lease - Contact

Gregg Medvin

Ph. 732-724-3962

gregg@piersonre.com

PIERSON
COMMERCIAL REAL ESTATE®